

MARION TOWNSHIP SECTION 16 R12 TWP 8 MORGAN COUNTY, OH

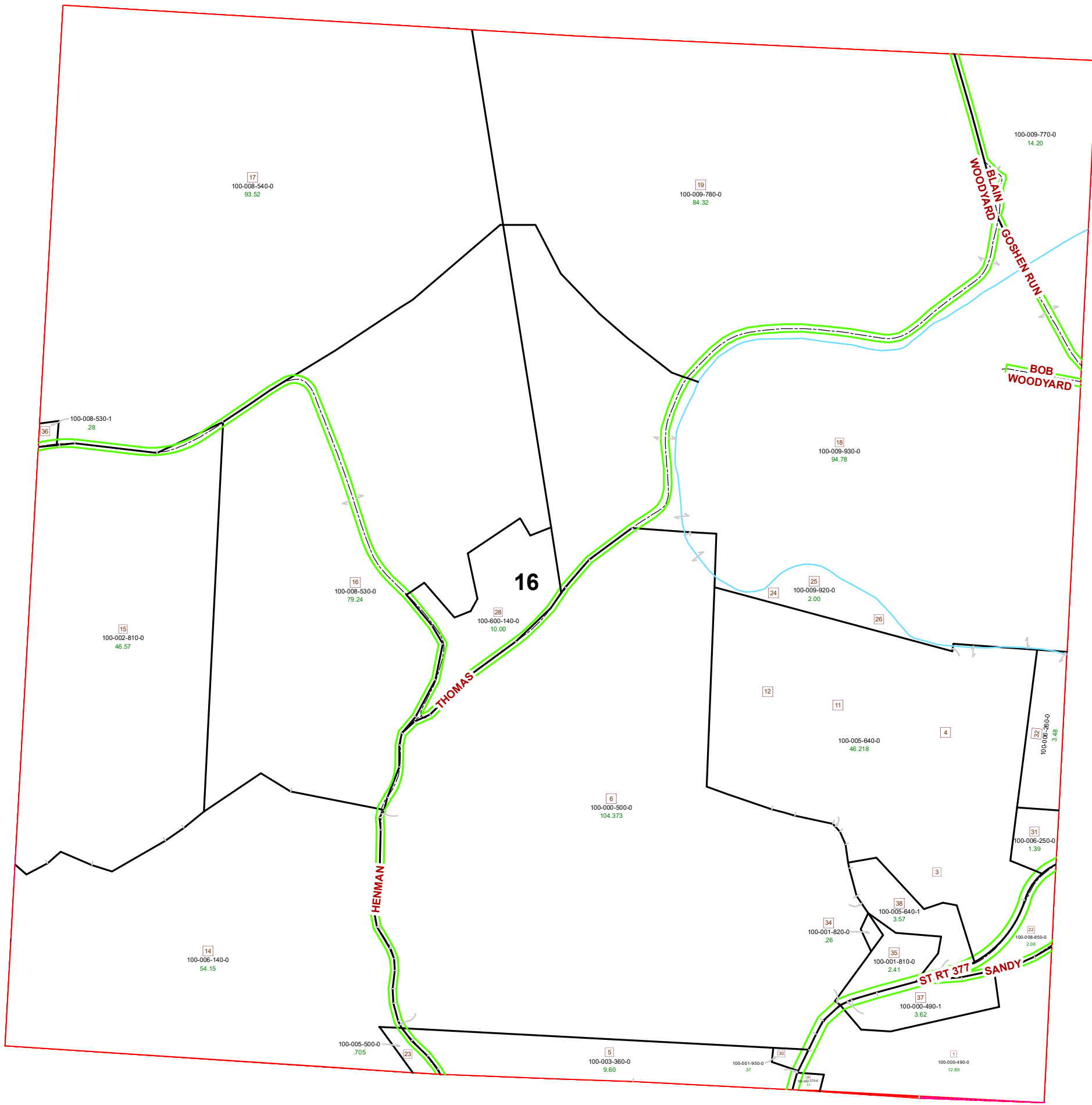

PIN	Owner	VOL	PAGE	LegalDescr	Acres
100-003-360-0	APOSTOLIC PENTECOSTAL CHURCH OF CHESTERHILL	OR 152	600	R12 T08 S16 SD 5	7.606
100-005-640-1	BERG ARTHUR D JR	OR222	2980	R12 T08 S16 SD 38	3.576
100-000-490-0	BOWMAN KENNETH WAYNE	OR215	2951	R12 T08 S16 SD 1	12.891
100-008-530-1	COX JOHN & CONNIE	OR199	171	R12 T08 S16 SD 36	0.283
100-008-850-0	GEWERTZ BONNIE RIZZO LINDA & KIRKBRIDE JAMES D	D.V 182	432	R12 T08 S16 SD 22 1/3 INTE	2.06
100-001-950-0	HORNER ROBIN	OR 202	2251	R12 T08 S16 SD 30	0.3703
100-009-770-0	JACKSON AARON & ADAM & ADESSA	OR190	236	R12 T08 S16 SD 21 LE-LAUR	14.2
100-009-780-0	JACKSON AARON & ADAM & ADESSA	OR190	236	R12 T08 S16 SD 19 LE-LAUR	84.32
100-008-530-0	MANSFIELD LESLEY	OR102	431	R12 T08 S16 SD 16	79.247
100-008-540-0	MANSFIELD LESLEY	OR102	431	R12 T08 S16 SD 17	93.521
100-003-370-0	MAYLE KATHY	OR226	1713	R12 T08 S16 SD 29	0.33
100-001-820-0	MAYLE STEPHANIE RAE	D.V 198	753	R12 T08 S16 SD 34	0.26
100-001-810-0	MAYLE STEPHANIE RAE	D.V 198	753	R12 T08 S16 SD 35	2.415
100-006-140-0	NEWTON DOW O & IRENE TRUSTEES OF TRUST	OR144	689	R12 T08 S16 SD 14	54.15
100-002-810-0	OSTLER DAVID WILLIAM & JONNA MARY C/O LESLIE M	OR157	12	R12 T08 S16 SD 15 SURVIV	46.571
100-006-250-0	PETTWAY EVEN CORNELL	OR231	4666	R12 T08 S16 SD 31	1.39
100-006-260-0	PETTWAY EVEN CORNELL	OR231	4666	R12 T08 S16 SD 32	3.48
100-009-920-0	POOL LYNDELL	OR222	2170	R12 T08 S16 SD 24-25-26	2
100-009-930-0	POOL LYNDELL	OR222	2170	R12 T08 S16 SD 18	94.78
100-005-500-0	TRIPLET BERNARD LEE	OR232	4858	R12 T08 S16 SD 23	0.705
100-600-140-0	VILLAGE OF CHESTERHILL	D.V 87	615	R12 T08 S16 LOT 28 CHEST	10
100-000-500-0	YODER MELVIN	OR212	2062	R12 T08 S16 SD 6 EX .25 AC	104.373
100-005-640-0	YODER MELVIN	OR219	416	R12 T08 S16 SD 3-4-11-12	46.218
100-000-490-1	YODER MELVIN A	OR222	1728	R12 T08 S16 SD 37	3.623

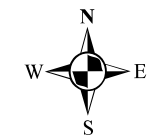

Boundaries	
--- Hidden	--- ROW
--- Hydro	--- Section
--- Roads	--- Lot
--- County	--- Township
--- Parcel	--- Parcels

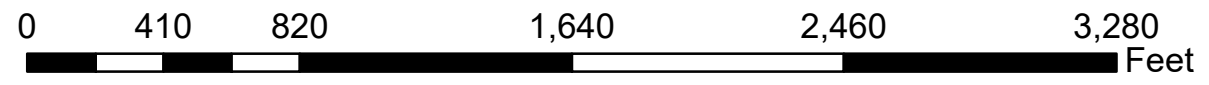

Disclaimer: The information that these maps contains is for reference purposes only. Please bring any errors to the attention of the Engineer's Office staff.
Thank you

Source: Morgan County Engineer's Office
Author: Marcia Wolfe
Date: 7/10/2020